

PROJECT INFORMATION

APPLICANT:
TODD VACURA

DRAWINGS BY:
ECCO DESIGN INC.
203 N 36TH ST SUITE 201
SEATTLE, WA 98103
206-706-3937

SITE ADDRESS:
8439 SE 87TH ST
MERCER ISLAND, WA 98040

PARCEL NUMBER:
773850-0775

BODY OF WATER:
LAKE WASHINGTON

LEGAL DESCRIPTION:
BENOTHO BEACH UNREC BEG ON THE WEST BDRY LN OF GL 2 STR 31-24-05 FR WCH PT THE NW COR OF SD LOT BRS N 00-05-04 E A DIST OF 961.55 FT TH N 89-58-20 E 76.66 FT TO THE TPOB TH CONT N 89-58-20 E 60.00 FT TH S 03-17-58 W 89.15 FT TH S 03-40-48 E 76.15 FT TO MEANDER LINE OF LAKE WASH SD PT BEING HINFTR REFERRED TO AS 'POINT X' TH ALG SD MEANDER LN S 89-58-20.4 W 65.00 FT TAP ON A LN 71.67 FT EAST OF AND PLT THE WEST BDRY LN OF SD GL 2 TH N 00-05-04 E 76.06 FT TH N 03-17-58 E 89.09 FT TO TPOB TGW POR OF SECOND CL SH LDS ADJ LY WLY OF FOLG DESC LN - BEG AT BEFORE MENTIONED 'POINT X' TH S 03-40-48 E TO OUTER LIMIT OF SD SECOND CL SH LDS SD NXN BEING THE TERM OF SD DESC LN - AKA AS POR OF LOTS 31 AND 32 OF BENOTHO BEACH UNREC PLAT "NEW LOT B" MERCER ISLAND BOUNDARY LINE ADJUSTMENT NO SUB 06-009 REC NO 20061013900007 PLAT LOT: 31-32

PROJECT DESCRIPTION:
REPLACE AN EXISTING ROCK BULKHEAD (64 LINEAL FEET). PLANT ONE SHORE PINE, TWO SCOUER WILLOWS, TWO RED-FLOWERING CURRANTS, AND ONE SNOWBERRY (SPACED @ 5' O.C. MIN FOR SHRUBS AND 10' O.C. FOR TREE). REMOVE 20 CUBIC YARDS OF ANGULAR ROCKS AND PLACE 25 CUBIC YARDS OF 2" MINUS SPAWNING GRAVEL.

VICINITY MAP

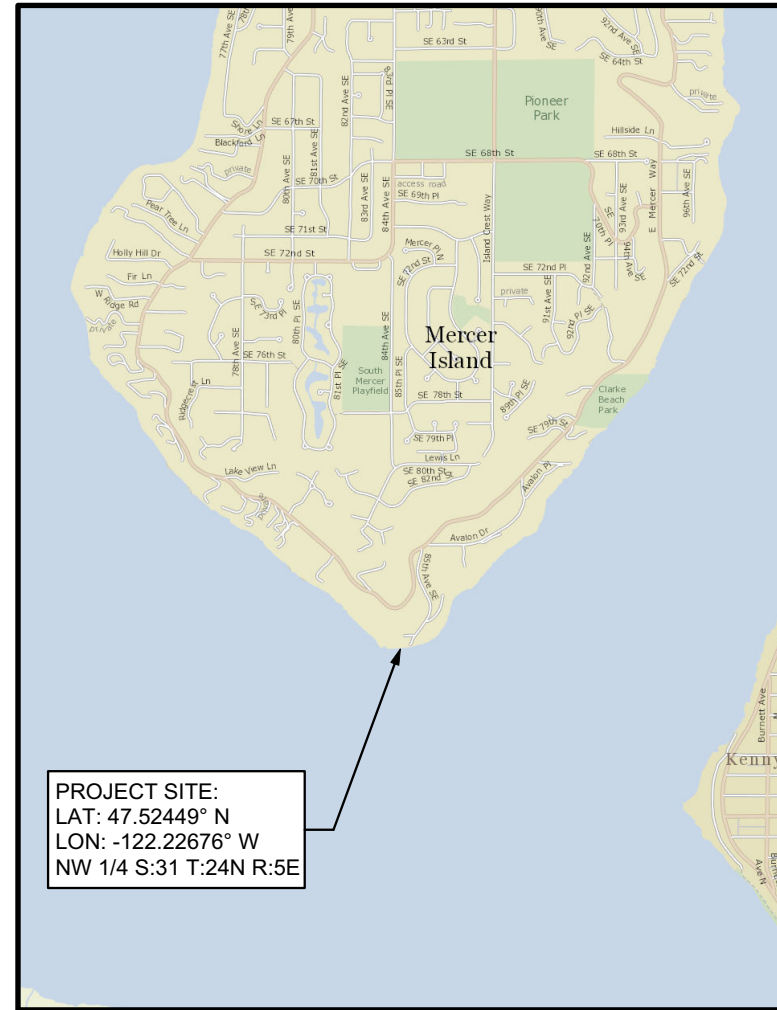

PLEASE NOTE THAT THE SHORELINE CONFIGURATION AND PROPERTY LINE LOCATIONS ARE APPROXIMATE ONLY. PROPERTY LINES ARE BASED ON SURVEY RECORDING # 20061013900007.

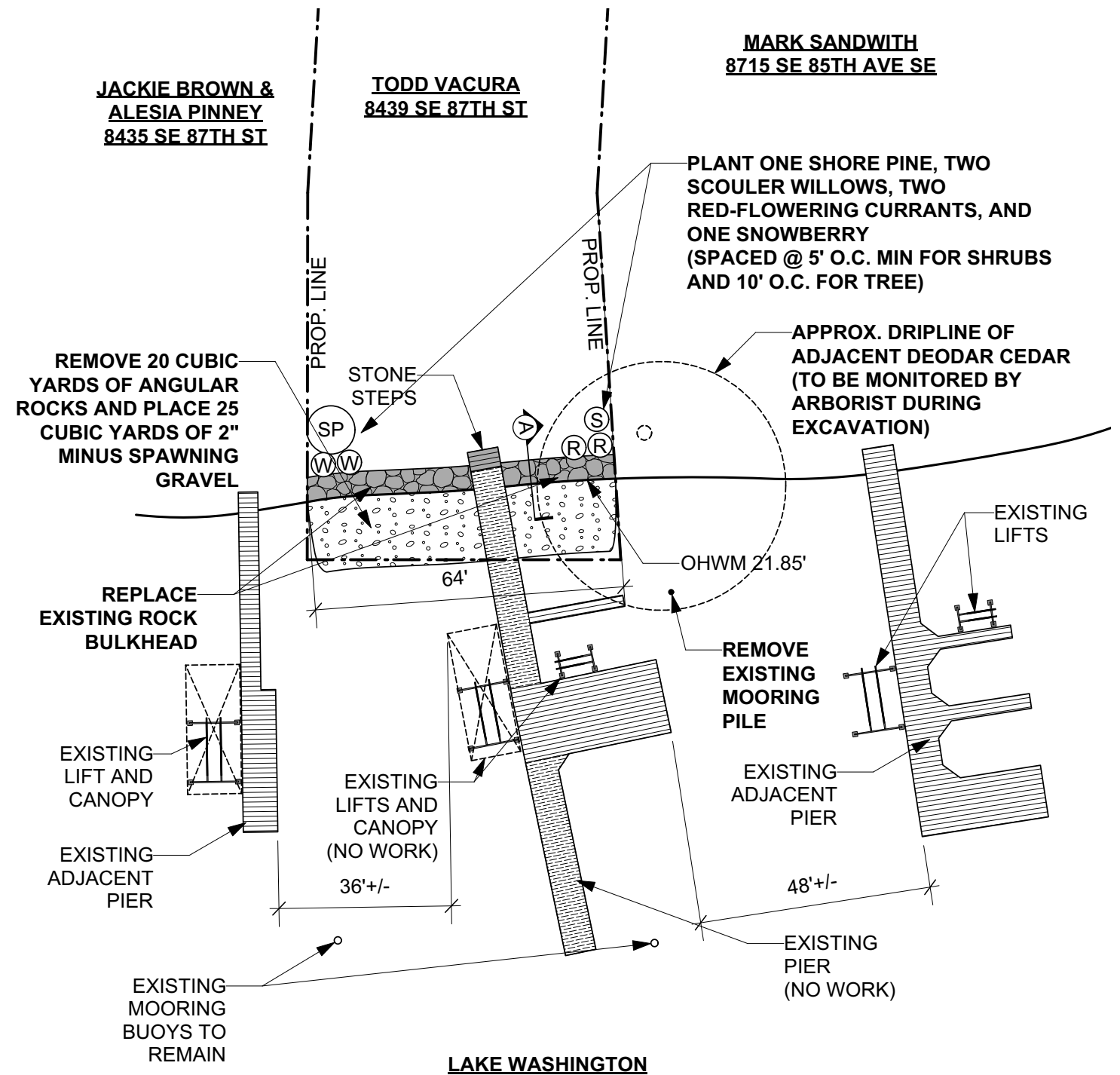

DATUM: C.O.E. Locks Datum

ADJACENT PROPERTY OWNERS:

1. Jackie Brown & Alesia Pinney
2. Mark Sandwith

SITE PLAN

SCALE 1" = 30'-0"



Reference:
Applicant: Todd Vacura

Proposed: Repair Bulkhead
Location: Mercer Island, WA

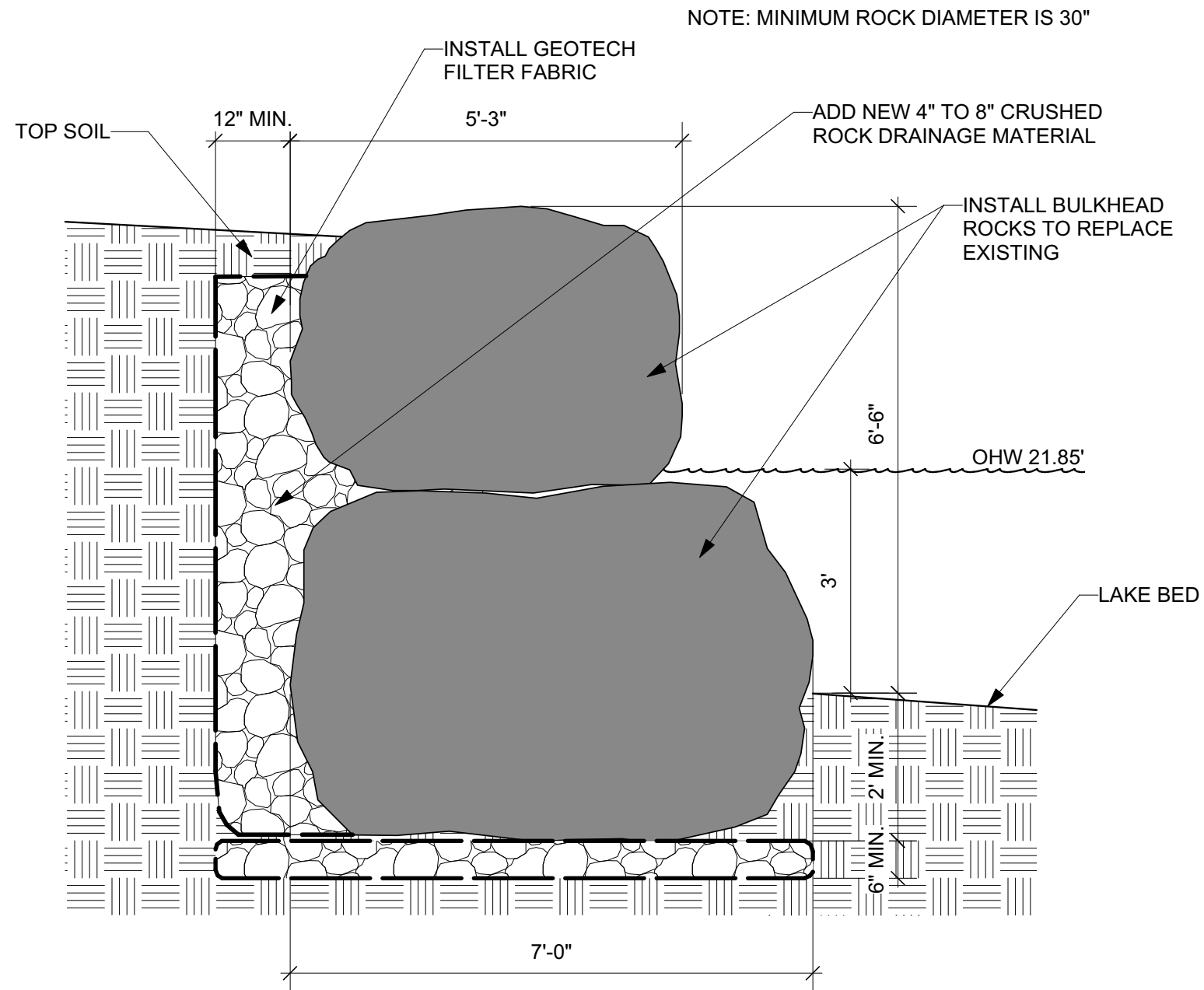

ROCK BULKHEAD SECTION - A

SCALE 1/2" = 1'-0"



Reference:
Applicant: Todd Vacura

Proposed: Repair Bulkhead
Location: Mercer Island, WA

Sheet 2 of 2 **Date:** 3/4/2020